

Espan 340[®] / 470[®]

COMMERCIAL ROOFING

FOR ADDITIONAL DETAILS - REFER
TO RESIDENTIAL ROOFING ESPAN

DETAIL LIST

		<u>Revision</u>	<u>Date</u>
D 01	RIDGE WITH PROFILED APEX	2.0	JAN 2023
D 02	SAWTOOTH RIDGE	2.0	JAN 2023
D 03	INTERNAL GUTTER	2.0	JAN 2023
D 04	FLUSH EAVE WITH EXTERNAL BRACKET	2.0	JAN 2023
D 05	FLUSH EAVE WITH EXTERNAL GUTTER BRACKET	2.0	JAN 2023
D 06	BARGE WITH PROFILED CLADDING	2.0	JAN 2023
D 07	PARAPET WITH TRANSVERSE APRON	2.0	JAN 2023
D 08	TRANSVERSE APRON	2.0	JAN 2023
D 09	PARALLEL APRON	2.0	JAN 2023

ACCEPTABLE SOLUTION AS PER E2/ASI			
	SITUATION 1	SITUATION 2	SITUATION 3
	1. LOW, MEDIUM, HIGH WIND ZONES, WHERE ROOF PITCH $\geq 10^\circ$	1. VERY HIGH WIND ZONE 2. LOW, MEDIUM AND HIGH WIND ZONES WHERE ROOF PITCH $\leq 10^\circ$	1. ALL ROOF PITCHES IN EXTRA HIGH WIND ZONE
X	MIN. 130mm	MIN. 200mm	MIN. 200mm
Z	MIN. 50mm	MIN. 70mm	MIN. 90mm

ALTERNATIVE SOLUTION AS PER MRM CODE OF PRACTICE	
CATEGORY A	CATEGORY B
1. NORMAL EXPOSURE 2. ROOF PITCH $>10^\circ$	1. EXPOSED (HIGHER RISK) & WIND LOAD EXCEEDS 1.5 kPa. 2. ROOF PITCH $<10^\circ$
X MIN. 130mm	MIN. 200mm
Z MIN. 50mm (VERTICALLY DOWN FACE - SMOOTH) MIN. 75mm (VERTICALLY DOWN FACE - PROFILED)	MIN. 75mm (VERTICALLY DOWN FACE - SMOOTH) MIN. 100mm (VERTICALLY DOWN FACE - PROFILED)

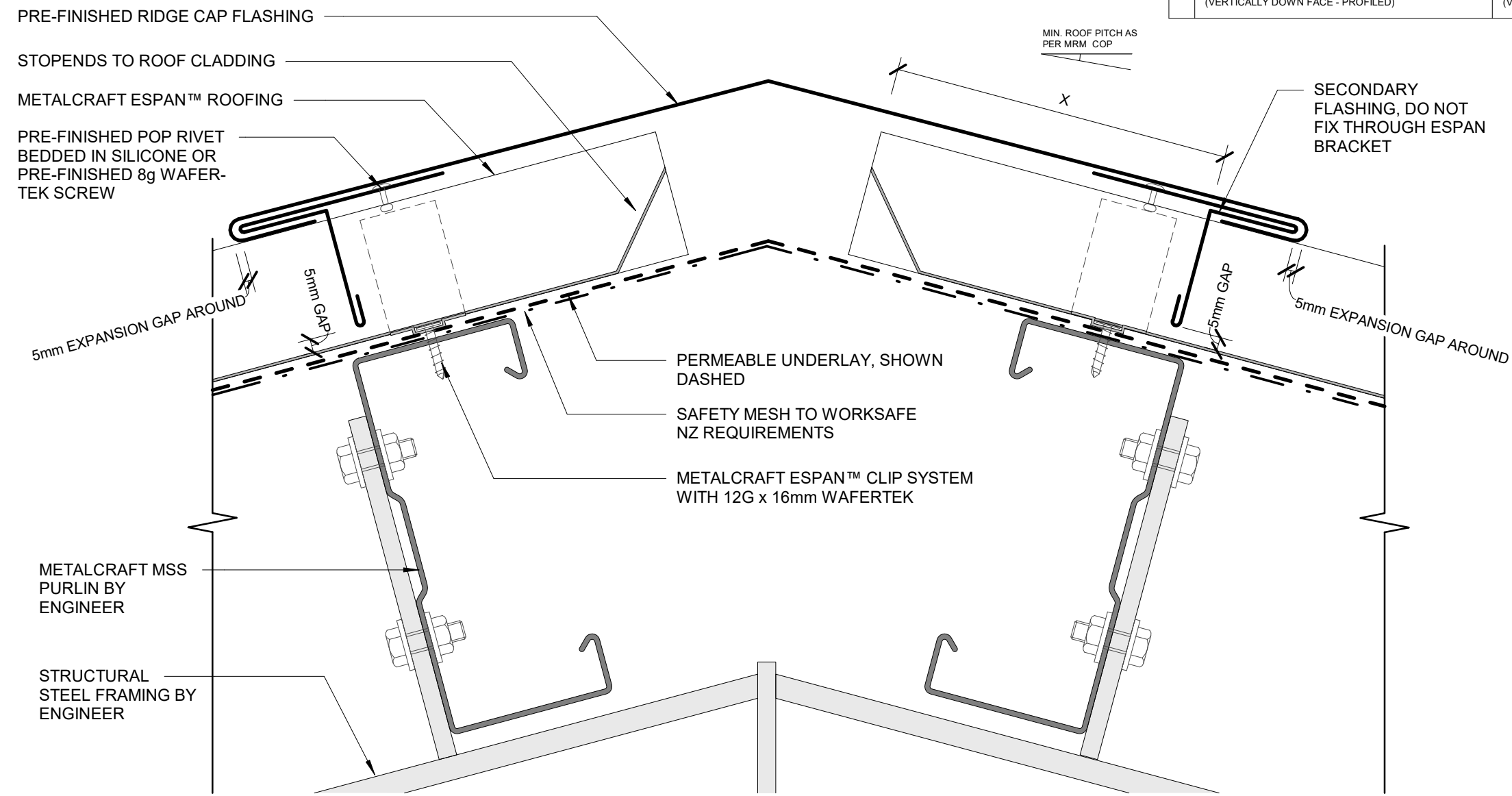

ACCEPTABLE SOLUTION AS PER E2/ASI			
	SITUATION 1	SITUATION 2	SITUATION 3
	1. LOW, MEDIUM, HIGH WIND ZONES, WHERE ROOF PITCH $\geq 10^\circ$	1. VERY HIGH WIND ZONE 2. LOW, MEDIUM AND HIGH WIND ZONES WHERE ROOF PITCH $\leq 10^\circ$	1. ALL ROOF PITCHES IN EXTRA HIGH WIND ZONE
X	MIN. 130mm	MIN. 200mm	MIN. 200mm
Z	MIN. 50mm	MIN. 70mm	MIN. 90mm

ALTERNATIVE SOLUTION AS PER MRM CODE OF PRACTICE		
	CATEGORY A	CATEGORY B
	1. NORMAL EXPOSURE 2. ROOF PITCH $> 10^\circ$	1. EXPOSED (HIGHER RISK) & WIND LOAD EXCEEDS 1.5 kPa. 2. ROOF PITCH $< 10^\circ$
X	MIN. 130mm	MIN. 200mm
Z	MIN. 50mm (VERTICALLY DOWN FACE - SMOOTH) MIN. 75mm (VERTICALLY DOWN FACE - PROFILED)	MIN. 75mm (VERTICALLY DOWN FACE - SMOOTH) MIN. 100mm (VERTICALLY DOWN FACE - PROFILED)

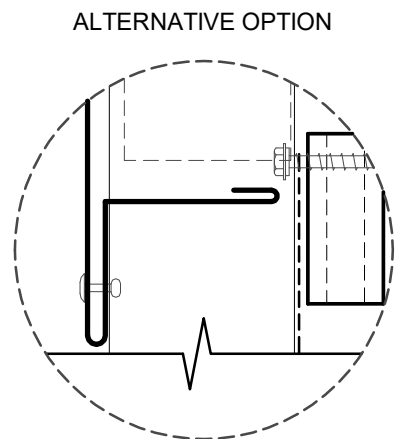
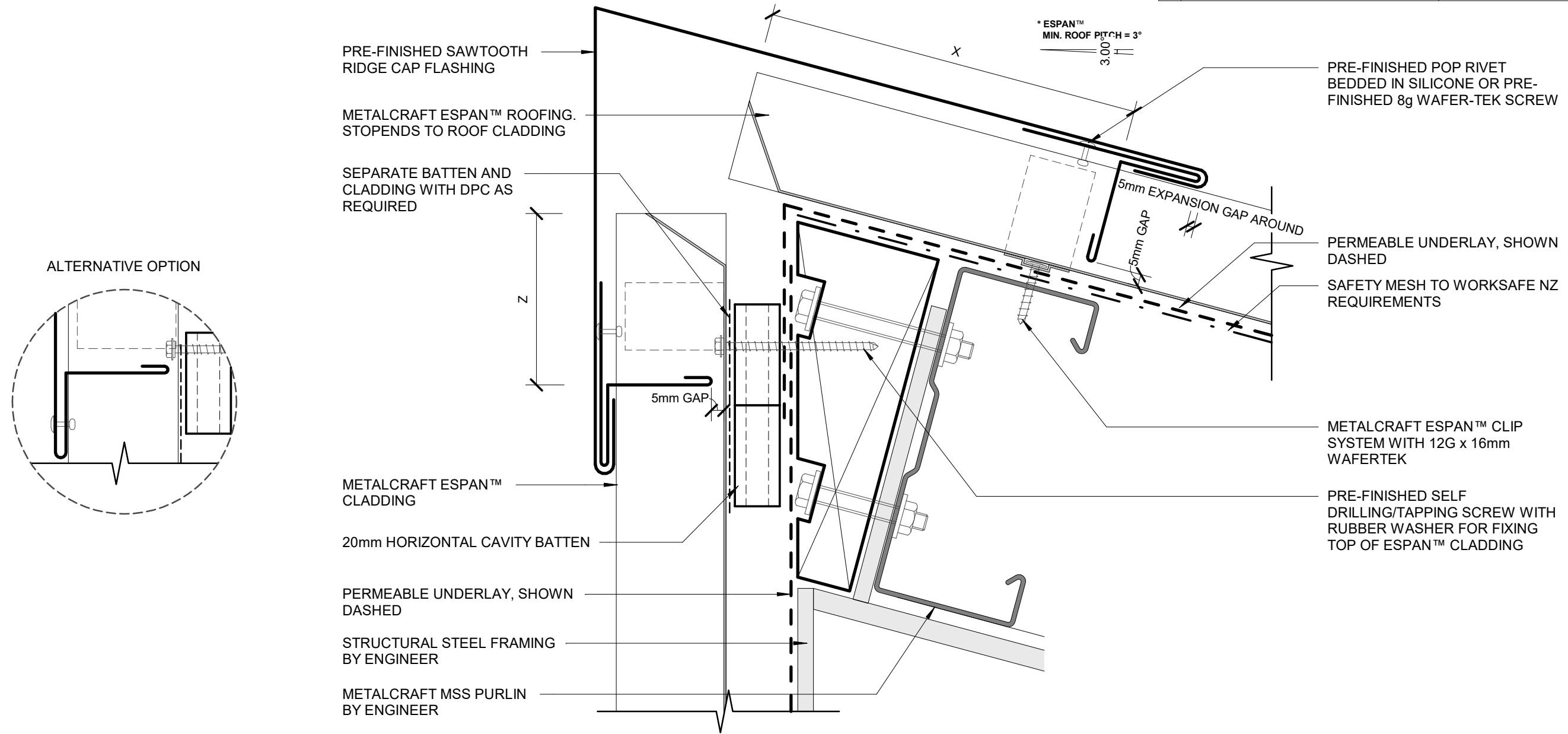

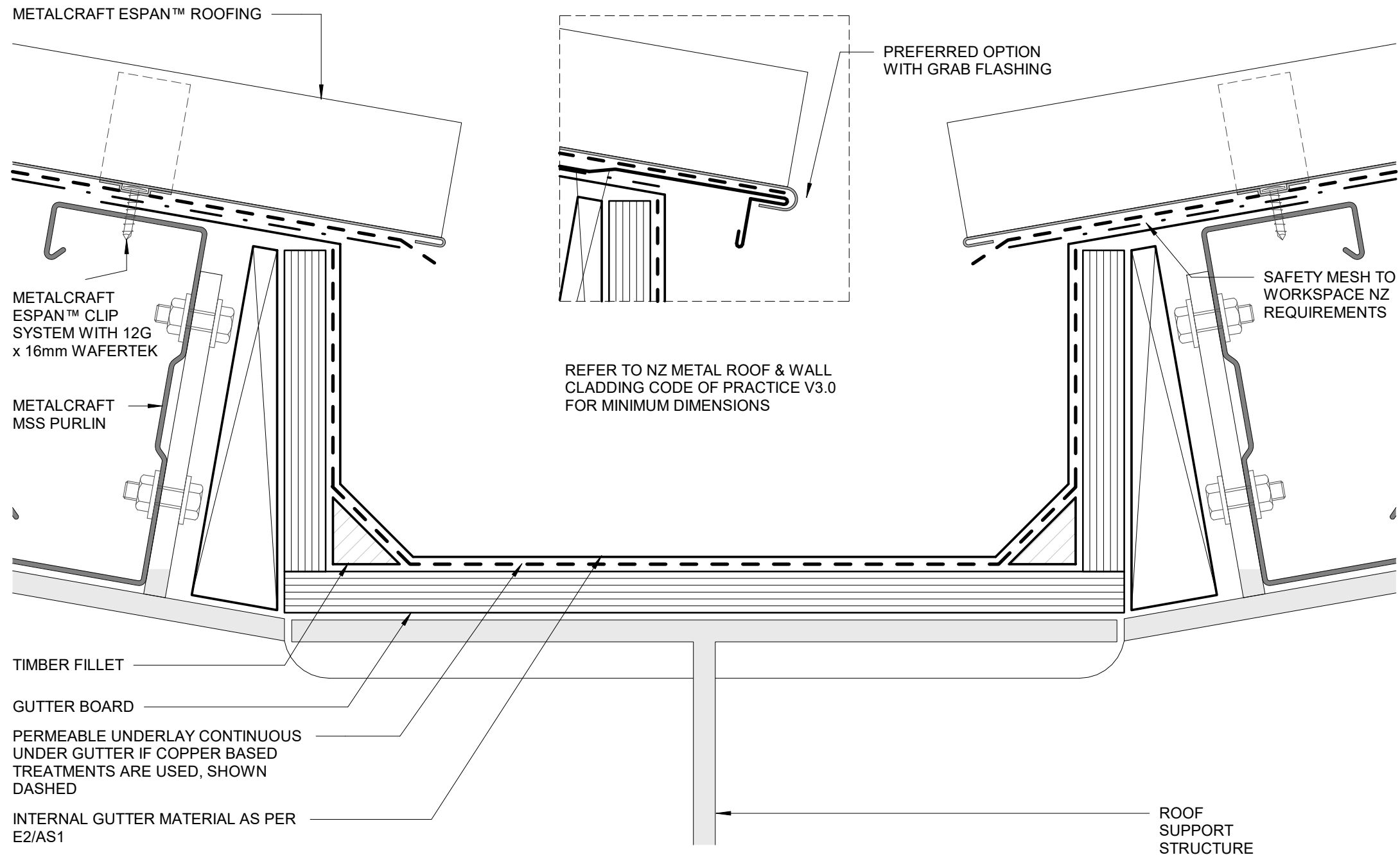

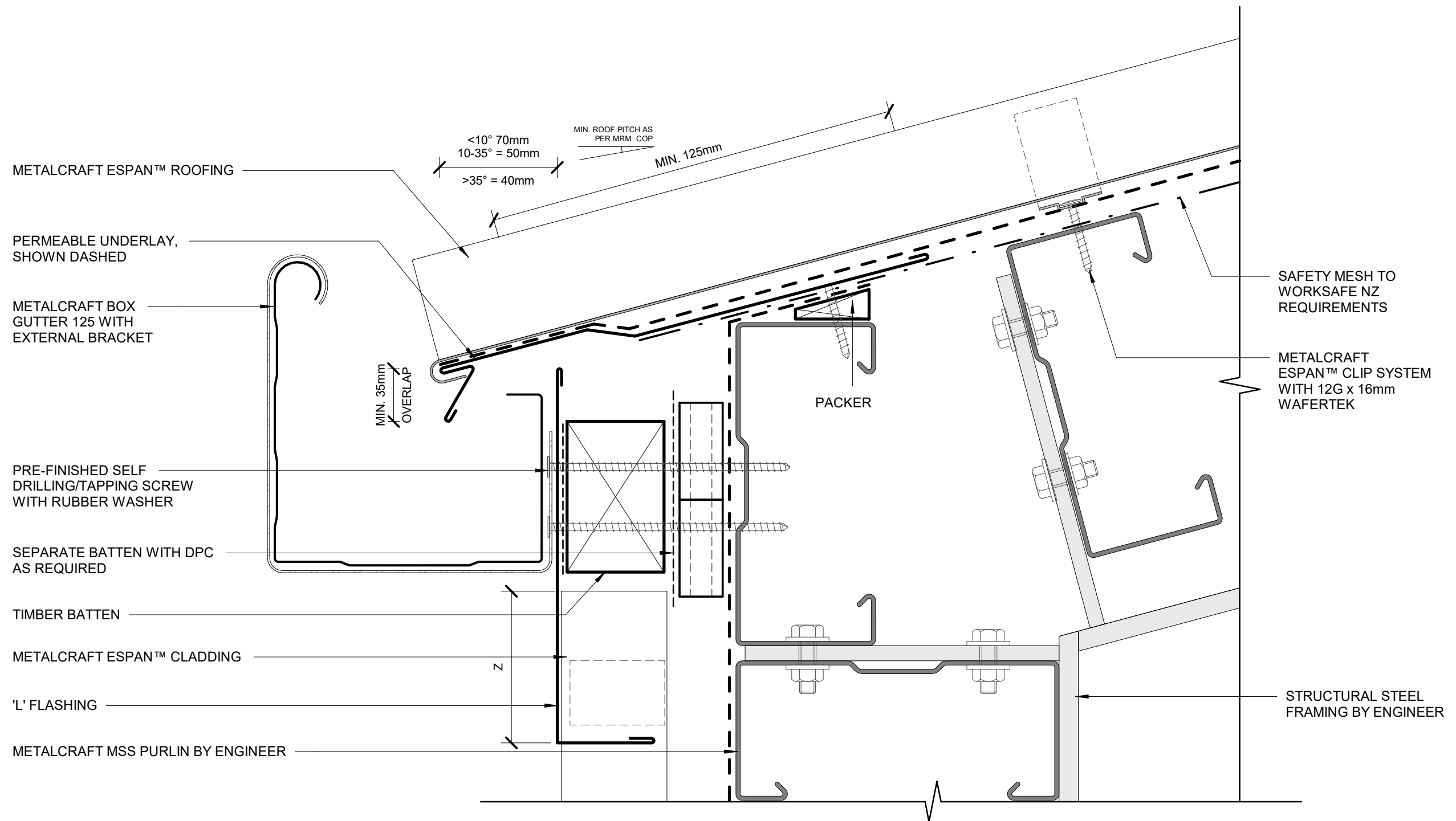

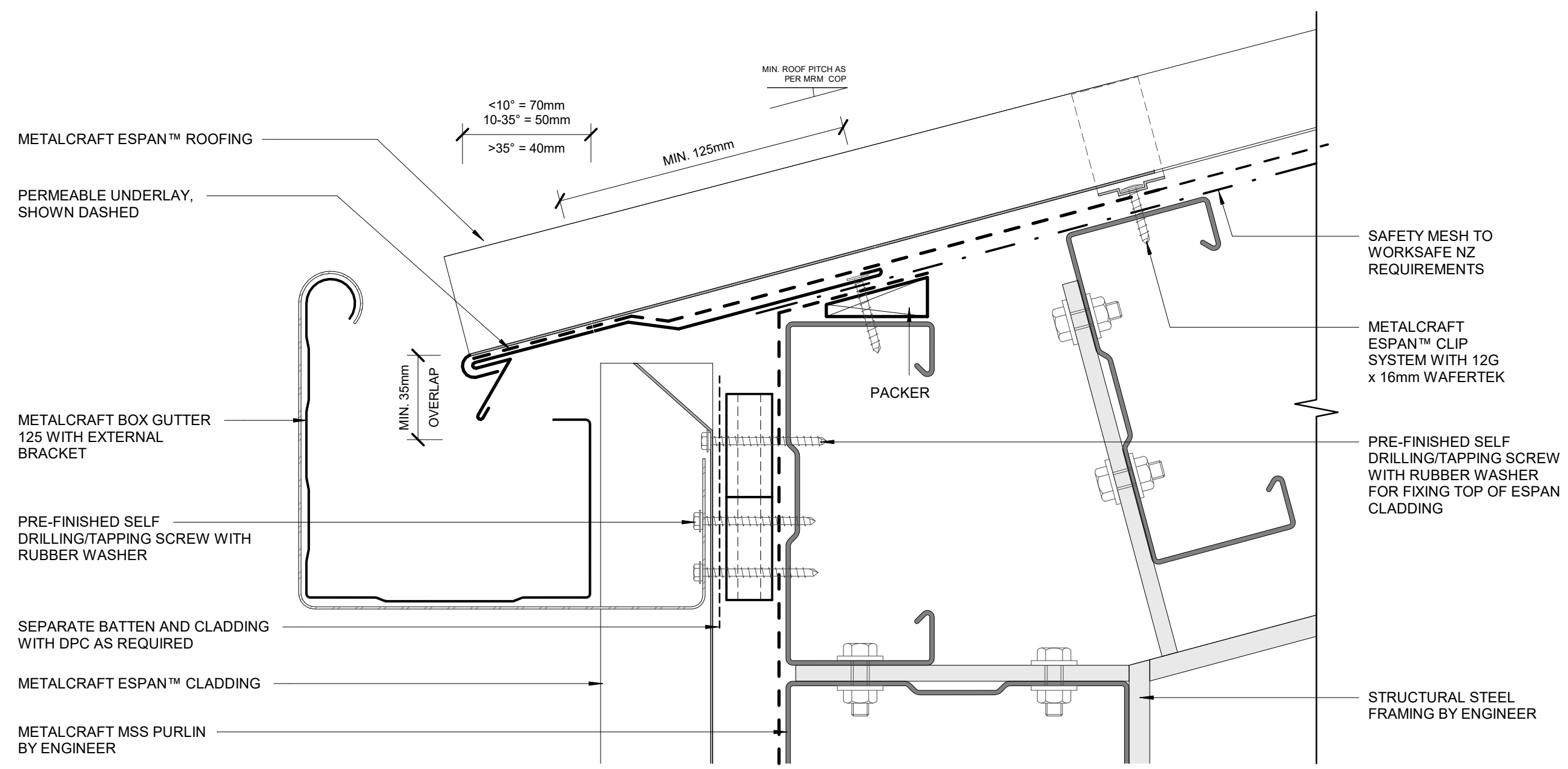

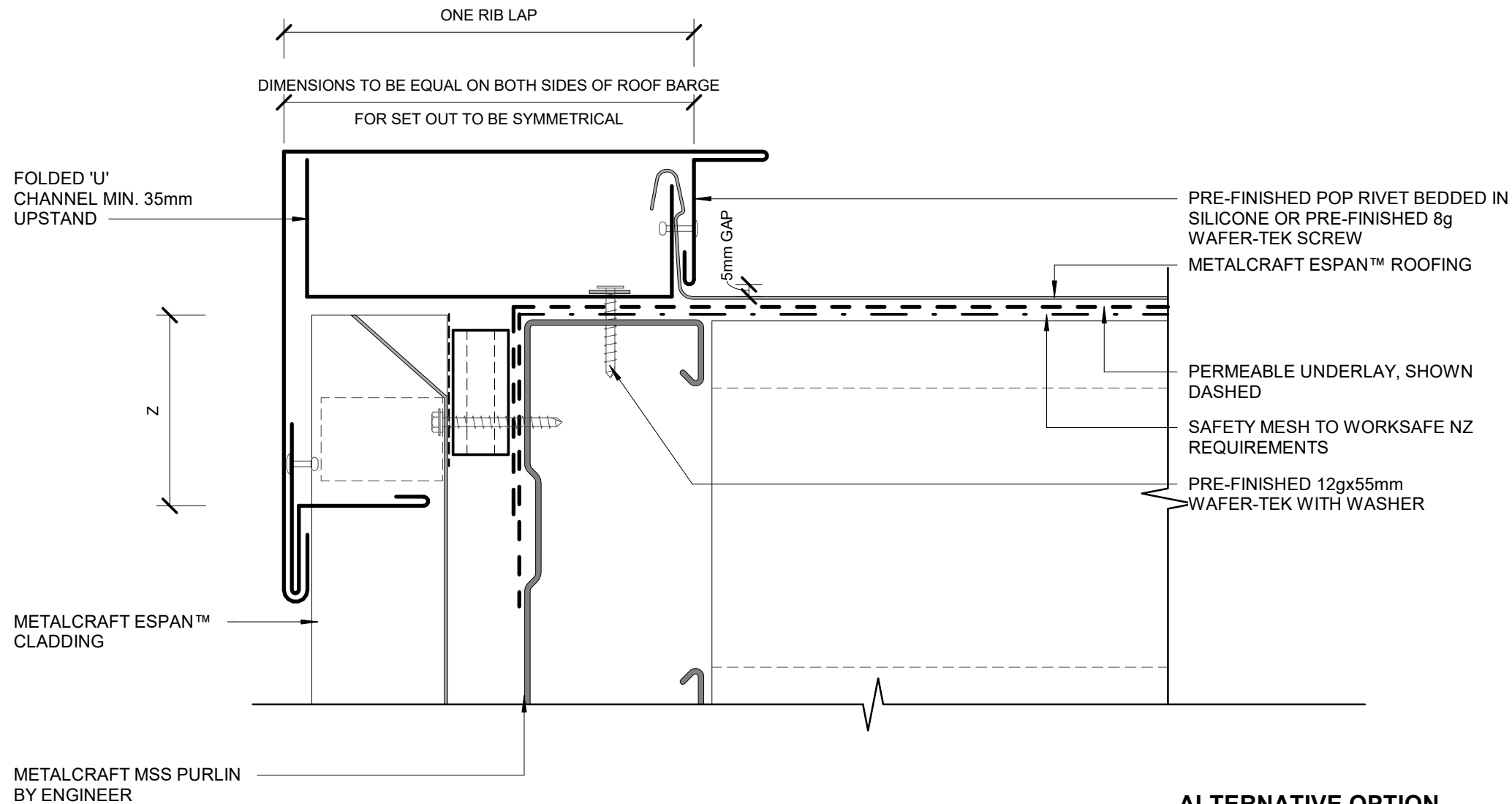

ACCEPTABLE SOLUTION AS PER E2/AS1		
SITUATION 1	SITUATION 2	SITUATION 3
1. LOW, MEDIUM, HIGH WIND ZONES, WHERE ROOF PITCH $\geq 10^\circ$	1. ALL ROOF PITCHES IN VERY HIGH WIND ZONE 2. LOW, MEDIUM, HIGH WIND ZONES WHERE ROOF PITCH $\leq 10^\circ$	1. FOR ALL ROOF PITCHES IN EXTRA HIGH WIND ZONES
Z MIN. 50mm	MIN. 70mm	MIN. 90mm

ALTERNATIVE SOLUTION AS PER MRM CODE OF PRACTICE	
CATEGORY A	CATEGORY B
1. NORMAL EXPOSURE 2. ROOF PITCH $>10^\circ$	1. EXPOSED (HIGHER RISK) & WIND LOAD EXCEEDS 1.5 kPa. 2. ROOF PITCH $<10^\circ$
Z MIN. 50mm (VERTICALLY DOWN FACE - SMOOTH) MIN. 75mm (VERTICALLY DOWN FACE - PROFILED)	MIN. 75mm (VERTICALLY DOWN FACE - SMOOTH) MIN. 100mm (VERTICALLY DOWN FACE - PROFILED)

ALTERNATIVE OPTION

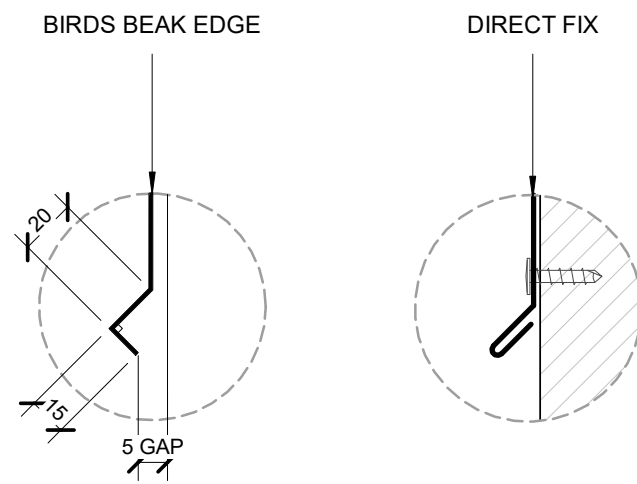
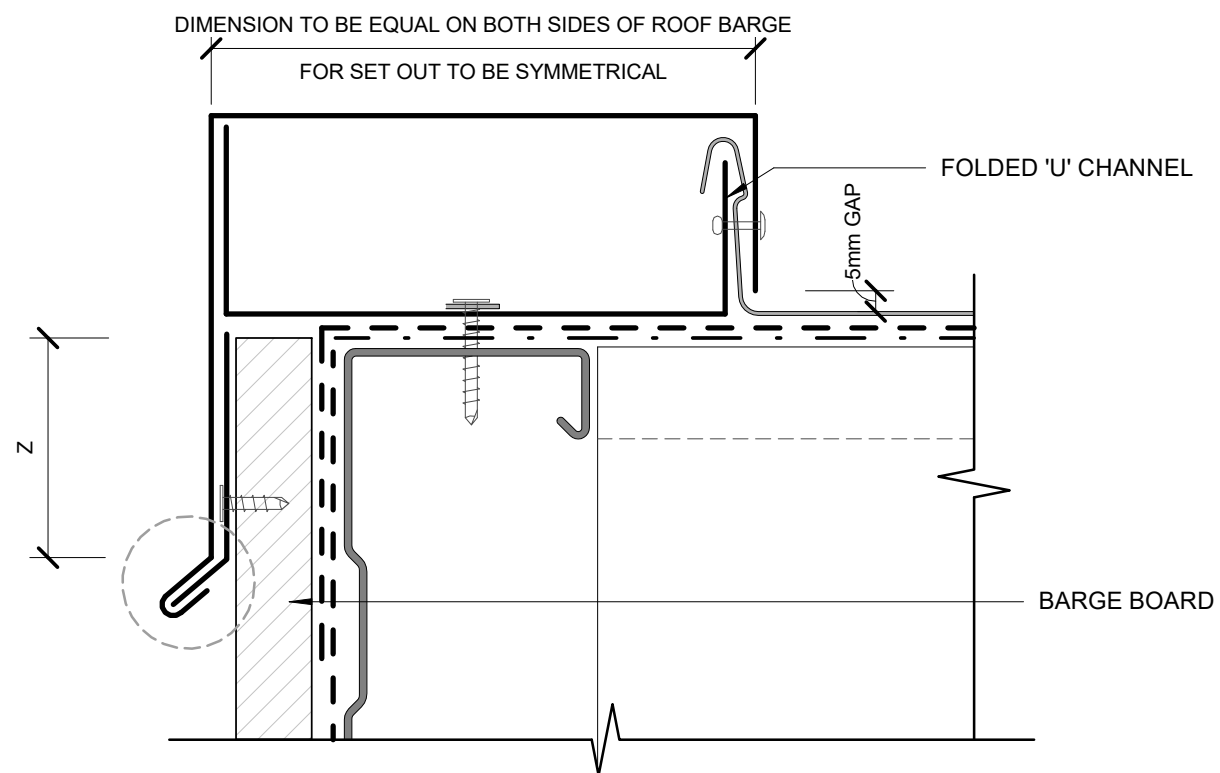

ACCEPTABLE SOLUTION AS PER E2/AS1			
	SITUATION 1	SITUATION 2	SITUATION 3
	1. LOW, MEDIUM, HIGH WIND ZONES, WHERE ROOF PITCH $\geq 10^\circ$	1. VERY HIGH WIND ZONE 2. LOW, MEDIUM AND HIGH WIND ZONES WHERE ROOF PITCHES $\leq 10^\circ$	1. ALL ROOF PITCHES IN EXTRA HIGH WIND ZONE
G	MIN. 35mm	MIN. 35mm	MIN. 35mm
N	MIN. 75mm	MIN. 75mm	MIN. 75mm
L	MIN. 130mm	MIN. 200mm	MIN. 200mm
Z	MIN. 50mm	MIN. 70mm	MIN. 90mm

ALTERNATIVE SOLUTION AS PER MRM CODE OF PRACTICE		
	CATEGORY A	CATEGORY B
	1. NORMAL EXPOSURE 2. ROOF PITCH $> 10^\circ$	1. EXPOSED (HIGHER RISK) & WIND LOAD EXCEEDS 1.5 kPa. 2. ROOF PITCH $> 10^\circ$
G	25mm	25mm
N	MIN. 50mm + HEM OR 75mm (VERTICALLY UP FACE - SMOOTH) MIN. 75mm + HEM OR 100mm (VERTICALLY UP FACE - PROFILED)	MIN. 75mm + HEM OR 100mm (VERTICALLY UP FACE - SMOOTH) MIN. 100mm + HEM OR 125mm (VERTICALLY UP FACE - PROFILED)
L	MIN. 150mm	MIN. 200mm
Z	MIN. 50mm (VERTICALLY DOWN FACE - SMOOTH) MIN. 75mm (VERTICALLY DOWN FACE - PROFILED)	MIN. 75mm (VERTICALLY DOWN FACE - SMOOTH) MIN. 100mm (VERTICALLY DOWN FACE - PROFILED)

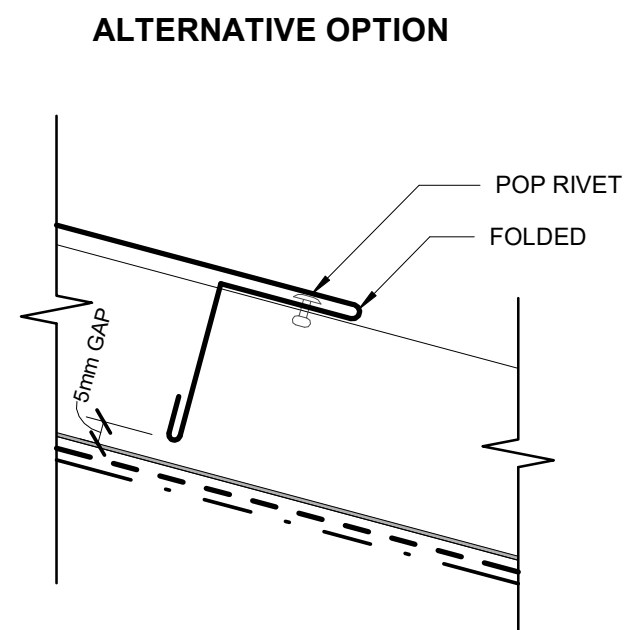
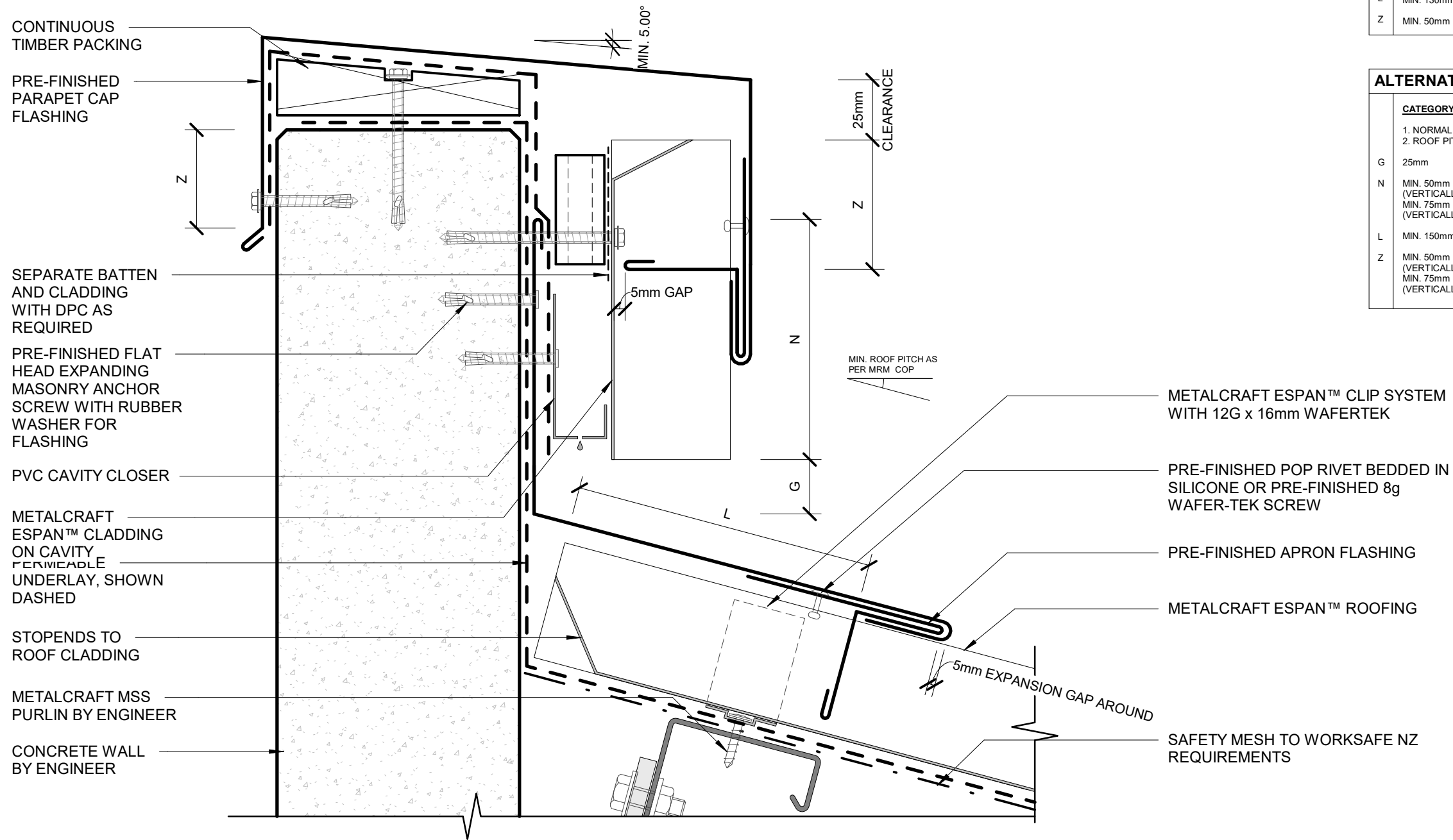

POLYSULPHIDE SEALANT

PRE-FINISHED EXPANDING MASONRY ANCHOR SCREW WITH RUBBER WASHER

PRE-FINISHED FLASHING OVER APRON FLASHING

PRE-FINISHED FLAT HEAD EXPANDING MASONRY ANCHOR SCREW WITH RUBBER WASHER FOR FLASHING

PERMEABLE UNDERLAY SHOWN DASHED

PRE-FINISHED APRON FLASHING

STOPENDS TO ROOF CLADDING

METALCRAFT ESPAN™ CLIP SYSTEM WITH 12G x 16mm WAFERTEK

SAFETY MESH TO WORKSAFE NZ REQUIREMENTS

CONCRETE WALL BY ENGINEER

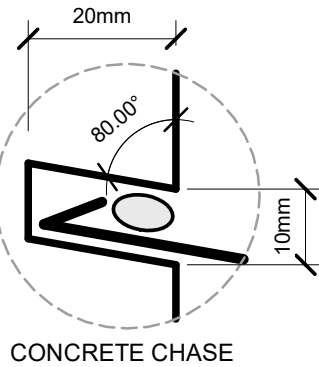

MIN. ROOF PITCH AS PER MRM COP

POP RIVET

METALCRAFT ESPAN™ ROOFING

METALCRAFT MSS PURLIN BY ENGINEER

ALTERNATIVE OPTION

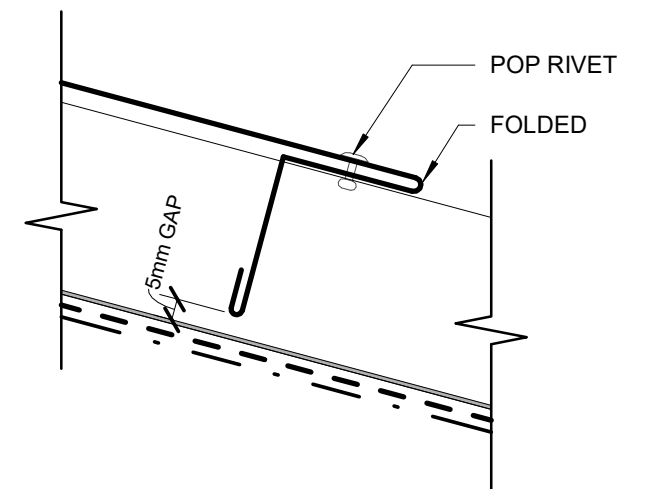

ACCEPTABLE SOLUTION AS PER E2/ASI		
SITUATION 1 1. LOW, MEDIUM, HIGH WIND ZONES, WHERE ROOF PITCH $\geq 10^\circ$	SITUATION 2 1. VERY HIGH WIND ZONE 2. LOW, MEDIUM, AND HIGH WIND ZONES WHERE ROOF PITCH $\leq 10^\circ$	SITUATION 3 1. ALL ROOF PITCHES EXTRA HIGH WIND ZONE
L MIN. 130mm	MIN. 200mm	MIN. 200mm

ALTERNATIVE SOLUTION AS PER MRM CODE OF PRACTICE	
CATEGORY A 1. NORMAL EXPOSURE 2. ROOF PITCH $>10^\circ$	CATEGORY B 1. EXPOSED (HIGHER RISK) & WIND LOAD EXCEEDS 1.5 kPa. 2. ROOF PITCH $<10^\circ$
L MIN. 150mm	MIN. 200mm

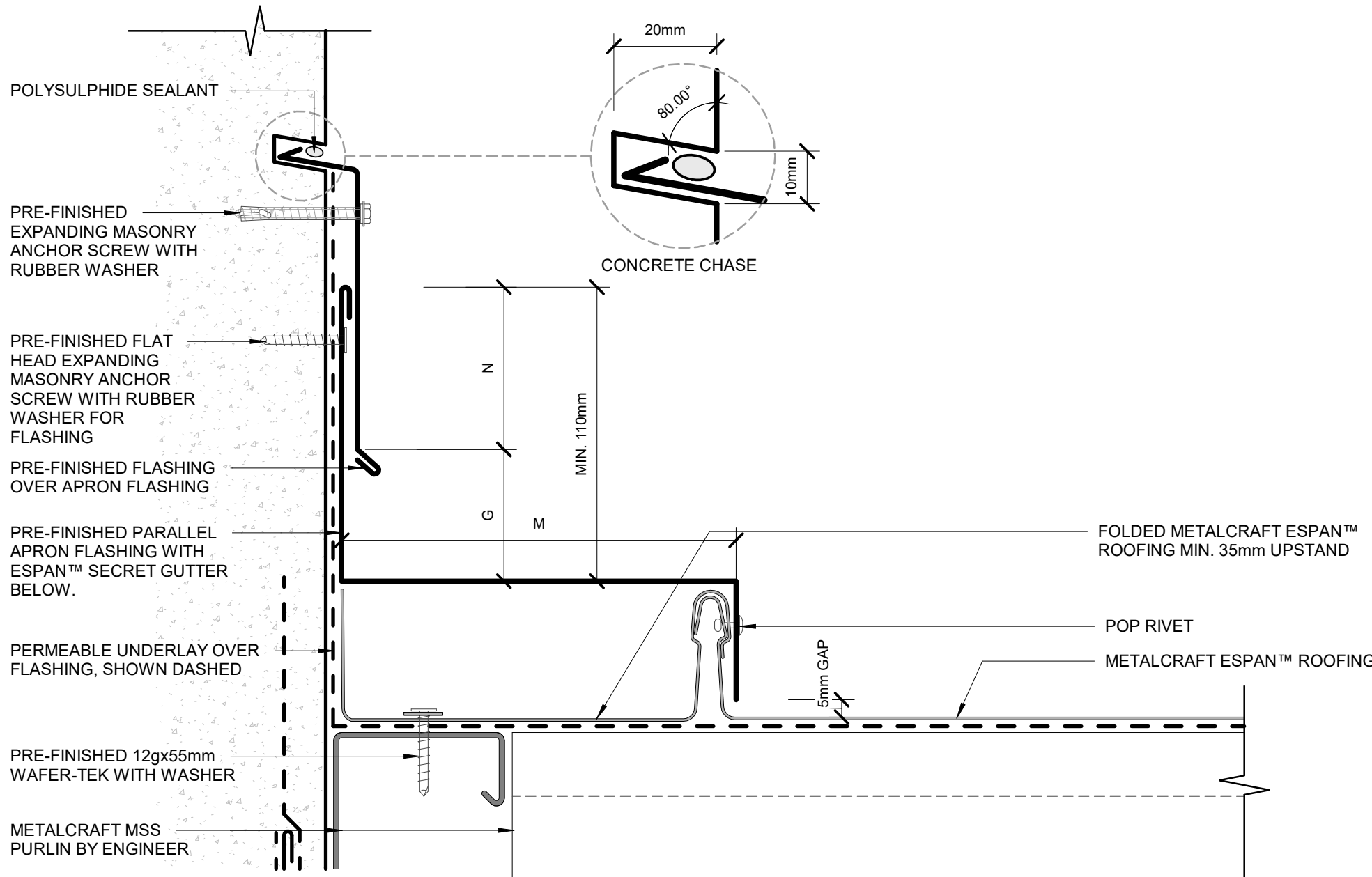

ACCEPTABLE SOLUTION AS PER E2/AS1		
SITUATION 1	SITUATION 2	SITUATION 3
1. LOW, MEDIUM, HIGH WIND ZONES, WHERE ROOF PITCH $\geq 10^\circ$	1. ALL ROOF PITCHES IN VERY HIGH WIND ZONE 2. LOW, MEDIUM, AND HIGH WIND ZONES WHERE ROOF PITCH $\leq 10^\circ$	1. ALL ROOF PITCHES IN EXTRA HIGH WIND ZONE
G MIN. 35mm	MIN. 35mm	MIN. 35mm
N MIN. 75mm	MIN. 75mm	MIN. 75mm
M AT LEAST TWO CRESTS	AT LEAST TWO CRESTS	AT LEAST TWO CRESTS

ALTERNATIVE SOLUTION AS PER MRM CODE OF PRACTICE	
CATEGORY A	CATEGORY B
1. NORMAL EXPOSURE 2. ROOF PITCH $>10^\circ$	1. EXPOSED (HIGHER RISK) & WIND LOAD EXCEEDS 1.5 kPa. 2. ROOF PITCH $<10^\circ$
G 25mm	25mm
N MIN. 50mm + HEM OR 75mm (VERTICALLY UP FACE - SMOOTH) MIN. 75mm + HEM OR 100mm (VERTICALLY UP FACE - PROFILED)	MIN. 75mm + HEM OR 100mm (VERTICALLY UP FACE - SMOOTH) MIN. 100mm + HEM OR 125mm (VERTICALLY UP FACE - PROFILED)
M ONE RIB	

ALTERNATIVE OPTION - A

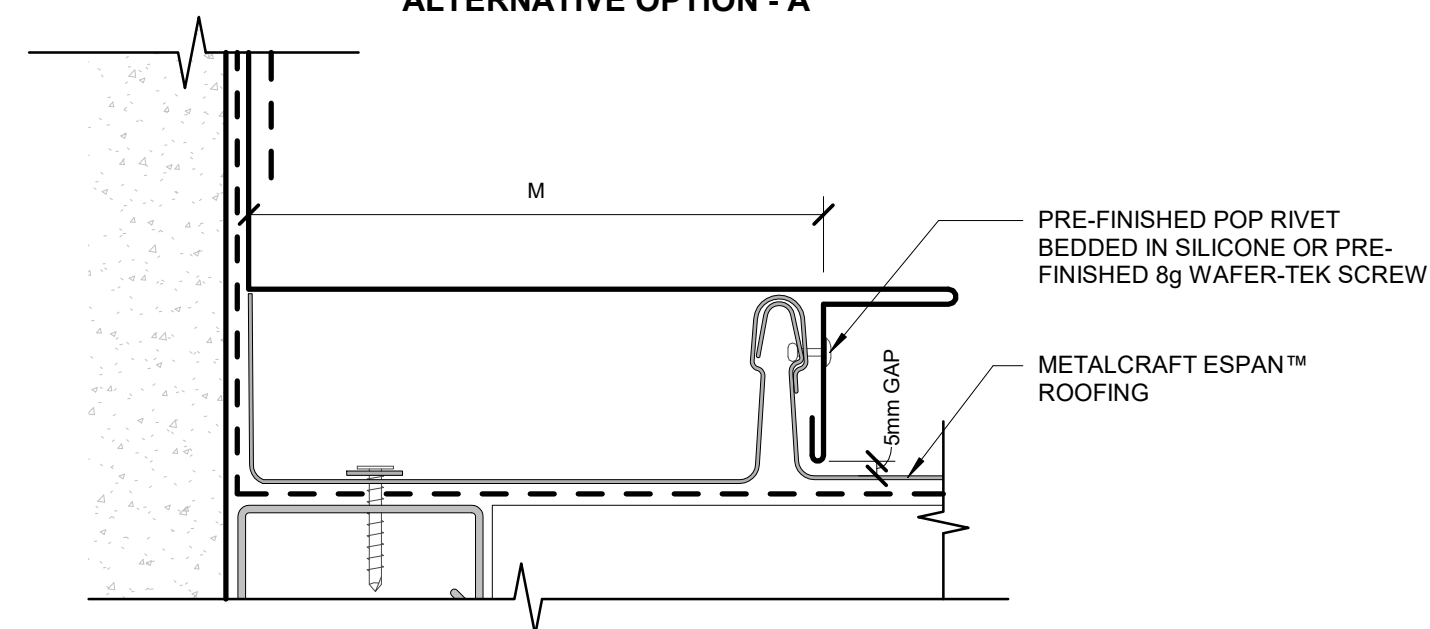

ALTERNATIVE OPTION - B

